

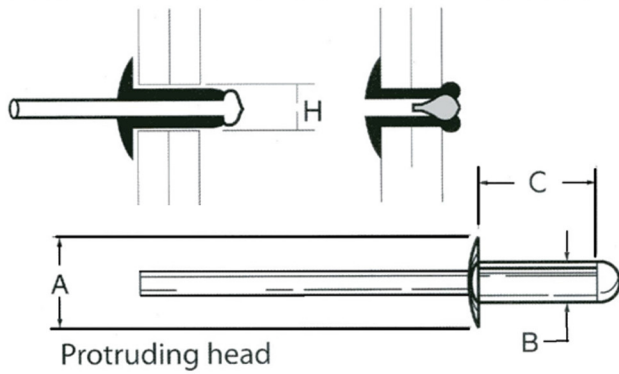

Top Screw Metal Corp.

螺峯金屬工業股份有限公司



Item size						TS.AAS	TS.SAS.		TS.SSAS.		TS.SSASS.		
	A (head DIA.)	B (body DIA.)	(inch)	C (length)	(inch)	Aluminum rivet		Steel Rivet		Stainless steel rivet		Stainless steel rivet	
						Steel	Shaft	Steel	Shaft	Steel	Shaft	Staniless steel	Shaft
3-2	4.5mm	2.4mm	(3/32)	5.8mm	(.23)	TS.AAS	3-2	TS.SAS	3-2				
3-3	4.5mm	2.4mm	(3/32)	7.4mm	(.30)	TS.AAS	3-3	TS.SAS	3-3				
3-4	4.5mm	2.4mm	(3/32)	8.4mm	(.33)	TS.AAS	3-4	TS.SAS	3-4				
4-1	6.4mm	3.2mm	(1/8)	4.8mm	(.19)	TS.AAS	4-1	TS.SAS	4-1	TS.SSAS.	4-2	TS.SSASS.	4-2
4-2	6.4mm	3.2mm	(1/8)	6.4mm	(.25)	TS.AAS	4-2	TS.SAS	4-2	TS.SSAS.	4-3	TS.SSASS.	4-3
4-3	6.4mm	3.2mm	(1/8)	8.0mm	(.315)	TS.AAS	4-3	TS.SAS	4-3	TS.SSAS.	4-4	TS.SSASS.	4-4
4-4	6.4mm	3.2mm	(1/8)	9.6mm	(.38)	TS.AAS	4-4	TS.SAS	4-4	TS.SSAS.	4-5(11)	TS.SSASS.	4-5(11)
4-5	6.4mm	3.2mm	(1/8)	11.5mm	(.45)	TS.AAS	4-5	TS.SAS	4-5	TS.SSAS.	4-6(12.3)	TS.SSASS.	4-6(12.3)
4-6	6.4mm	3.2mm	(1/8)	12.7mm	(.50)	TS.AAS	4-6	TS.SAS	4-6				
4-8	6.4mm	3.2mm	(1/8)	16.1mm	(.63)	TS.AAS	4-8	TS.SAS	4-8				
5-1	8.0mm	4.0mm	(5/32)	5.8mm	(.23)	TS.AAS	5-1	TS.SAS	5-1	TS.SSAS.	5-2	TS.SSASS.	5-2
5-2	8.0mm	4.0mm	(5/32)	7.0mm	(.275)	TS.AAS	5-2	TS.SAS	5-2	TS.SSAS.	5-3	TS.SSASS.	5-3
5-3	8.0mm	4.0mm	(5/32)	8.5mm	(.335)	TS.AAS	5-3	TS.SAS	5-3	TS.SSAS.	5-4	TS.SSASS.	5-4
5-4	8.0mm	4.0mm	(5/32)	10.0mm	(.394)	TS.AAS	5-4	TS.SAS	5-4	TS.SSAS.	5-5	TS.SSASS.	5-5
5-5	8.0mm	4.0mm	(5/32)	11.4mm	(.448)	TS.AAS	5-5	TS.SAS	5-5	TS.SSAS.	5-6	TS.SSASS.	5-6
5-6	8.0mm	4.0mm	(5/32)	13.0mm	(.511)	TS.AAS	5-6	TS.SAS	5-6	TS.SSAS.	5-8	TS.SSASS.	5-8
5-8	8.0mm	4.0mm	(5/32)	16.5mm	(.65)	TS.AAS	5-8	TS.SAS	5-8				
5-10	8.0mm	4.0mm	(5/32)	19.5mm	(.77)	TS.AAS	5-10	TS.SAS	5-10				
6-1	9.5mm	4.8mm	(3/16)	6.4mm	(.25)	TS.AAS	6-1	TS.SAS	6-1	TS.SSAS.	6-2	TS.SSASS.	6-2
6-2	9.5mm	4.8mm	(3/16)	7.4mm	(.30)	TS.AAS	6-2	TS.SAS	6-2		6-4(10.5)		6-4(10.5)
6-3	9.5mm	4.8mm	(3/16)	9.6mm	(.38)	TS.AAS	6-3	TS.SAS	6-3	TS.SSAS.		TS.SSASS.	
6-4	9.5mm	4.8mm	(3/16)	11.0mm	(.44)	TS.AAS	6-4	TS.SAS	6-4				
6-5	9.5mm	4.8mm	(3/16)	12.7mm	(.50)	TS.AAS	6-5	TS.SAS	6-5	TS.SSAS.	6-6(13.5)	TS.SSASS.	6-6(13.5)
6-6	9.5mm	4.8mm	(3/16)	14.5mm	(.57)	TS.AAS	6-6	TS.SAS	6-6	TS.SSAS.	6-8(16.5)	TS.SSASS.	6-8(16.5)
6-8	9.5mm	4.8mm	(3/16)	17.5mm	(.69)	TS.AAS	6-8	TS.SAS	6-8				
6-10	9.5mm	4.8mm	(3/16)	20.4mm	(.80)	TS.AAS	6-10	TS.SAS	6-10				
6-12	9.5mm	4.8mm	(3/16)	24.0mm	(.95)	TS.AAS	6-12	TS.SAS	6-12				

Tel: +886-4-7237159 Fax: +886-4-7246640
 Mail: receipt@topscrew.com.tw
 78, Lane 415, Tay Ho RD., Sec. 2, Ku Yi Li,
 Changhua City, Taiwan, R.O.C.

TEL: 04-7237159 FAX: 04-7246640
 E-mail: receipt@topscrew.com.tw
 網站: <https://www.topscrew.com.tw/>
 地址: 彰化縣彰化市古夷里泰和路二段415巷78號



Top Screw Metal Corp.

螺峯金屬工業股份有限公司

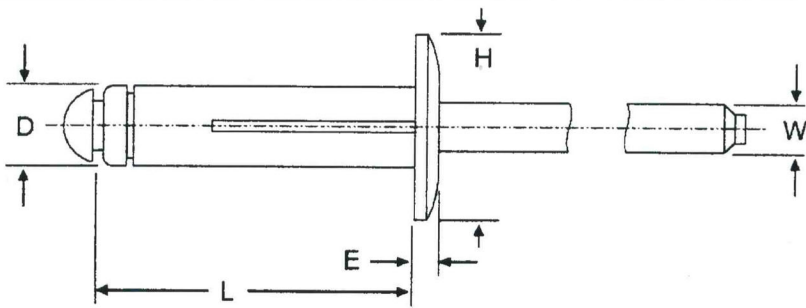

P/N. (MM)	D RIVET DIA.	HOLE SIZE DRILLING DIA.	L LENGTH	W MANDREL DIA.	H FLANGE DIA.	E FLANGE THICKNESS	GRIP RANGE
TS514	4.0 (5/32")	4.2-4.3	14.5	2.25	8.0	1.4	1.0-3.0
TS519	4.0 (5/32")	4.2-4.3	19.5	2.25	8.0	1.4	1.0-7.0
TS617	5.0 (1/5")	5.1-5.2	17.0	2.90	9.8	1.9	1.0-4.0
TS622	5.0 (1/5")	5.1-5.2	22.0	2.90	9.8	1.9	1.0-9.0
TS625	5.0 (1/5")	5.1-5.2	25.0	2.90	9.8	1.9	4.0-12.0

RIVET BODY MATERIAL: Aluminum 5052.

MANDREL MATERIAL: Aluminum 5056.

Suitable Applications:

Supports brittle, thin soft or ductile materials and functions when used with oversized, misaligned or irregularly shaped holes.

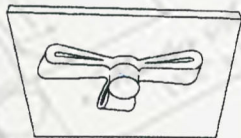

Backside

The Stretch Folding Blind Rivet forms three large folding legs that create excellent clamping-up and a large blind side bearing surface.

Multi Grip:

- Adjusts to a wide variation of subject's thickness.
- Finish available in a multiple of colours.

Positive Mandrel Retention:

- Rattle free fastener.

Corrosion Resistant:

- All aluminum construction.

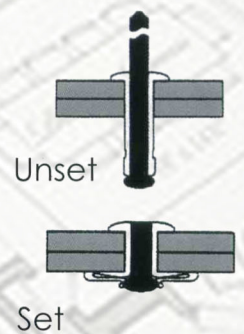

Tel: +886-4-7237159 Fax: +886-4-7246640
 Mail: recept@topscrew.com.tw
 78, Lane 415, Tay Ho RD., Sec. 2, Ku Yi Li,
 Changhua City, Taiwan, R.O.C.

TEL: 04-7237159 FAX: 04-7246640
 E-mail: recept@topscrew.com.tw
 網站: <https://www.topscrew.com.tw/>
 地址: 彰化縣彰化市古夷里泰和路二段415巷78號